

WALLET

Fingerprint enabled Cryptocurrency Wallet

Fingerprint Cold Wallet

Standalone mode for total asset query and QR code

BLE mode for iOS and Android app

USB mode for Windows/Mac/Browsers

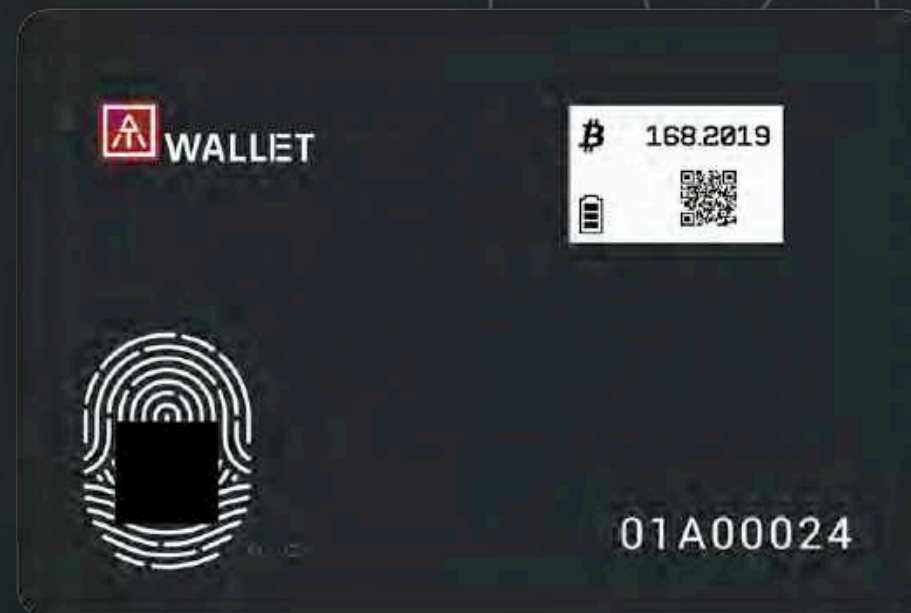

User Guide Rev: 1.8

20 August 2020



Designed with EAL 5+ SE (Infineon SLE97) to secure Private key and algorithm



Support standalone mode, to work with Mobile app via BLE and PC via USB



Multiple wallets supported; Multiple cryptocurrencies supported; Capable to add new currencies



Fingerprint matching to access Wallet and transactions; not unsecure PIN code anymore

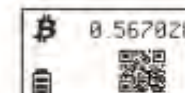

Build-in E-Ink to display indicators, text and QR code, multiple languages enabled



Fully compliance with BIP32, BIP39 and BIP44; support multi-lingual mnemonic by BIP39



**We believe in a brave new world,
where you are the key to
everything.**

”

Make your Wallet Secure.
Patented Standalone Mode.
USB + BLE dual interface.
Multiple Wallets and Cryptocurrencies.



CEO

Chief Executive Officer

Page 4
Before Starts

Outlook Page 5

AT. Wallet Diagram Page 7

Quick Start Page 8

Page 12
Mobile App

BLE Pairing Page 14

Fingerprint Enrollment Page 15

Login to Initial Wallet Page 16

Add Cryptocurrencies Page 18

Transaction - Receive Page 21

Transaction - Send Page 22

Additional Settings Page 23

Page 37
Standalone Mode

LED Display Page 39

Highlights & Notes Page 40

Regulations Page 41

Page 28
Windows
/ Mac App

BLE Pairing Page 29

Fingerprint Enrollment Page 30

Login to Initial Wallet Page 31

Add Cryptocurrencies Page 34

Transaction - Receive Page 35

Transaction - Send Page 36

Additional Settings Page 37



Congratulations! You've got your AT.Wallet. Your AT.Wallet will be ready to use in a few moments. Thank you and enjoy!

- 1) Open up the box and get comfortable with the hardware.
- 2) Check your box contents.
 - 1 Hardware Wallet
 - 1 USB Cable
 - 2 Recovery Sheets
 - 1 USB Docking

Setting up





Standalone mode

Single-click - Toggle to The Next Page

- Power ON
- Verify Fingerprint
- Loading → Main Wallet
- 1st Cryptocurrency Summary
- 1st Cryptocurrency QR Code
- 1st Cryptocurrency Address
- 2nd Cryptocurrency Summary

...

BLE Mode Power-Saving Policy:

- When AT.Wallet card connects with host app (BLE mode) and there are no operations (app and card) for 60 sec., BLE will disconnect (avoid battery consuming continuously) and the app will remind you about "Session Expired".
- If AT.Wallet card has no BLE or USB connection, it will power off automatically after 120 sec. without any operations to avoid battery consumption.
- Please "Log out" from App and click a specific wallet card to log in again by fingerprint.

1x AT.Wallet card → 2x Wallet(s) per card → 10x Cryptocurrencies per wallet

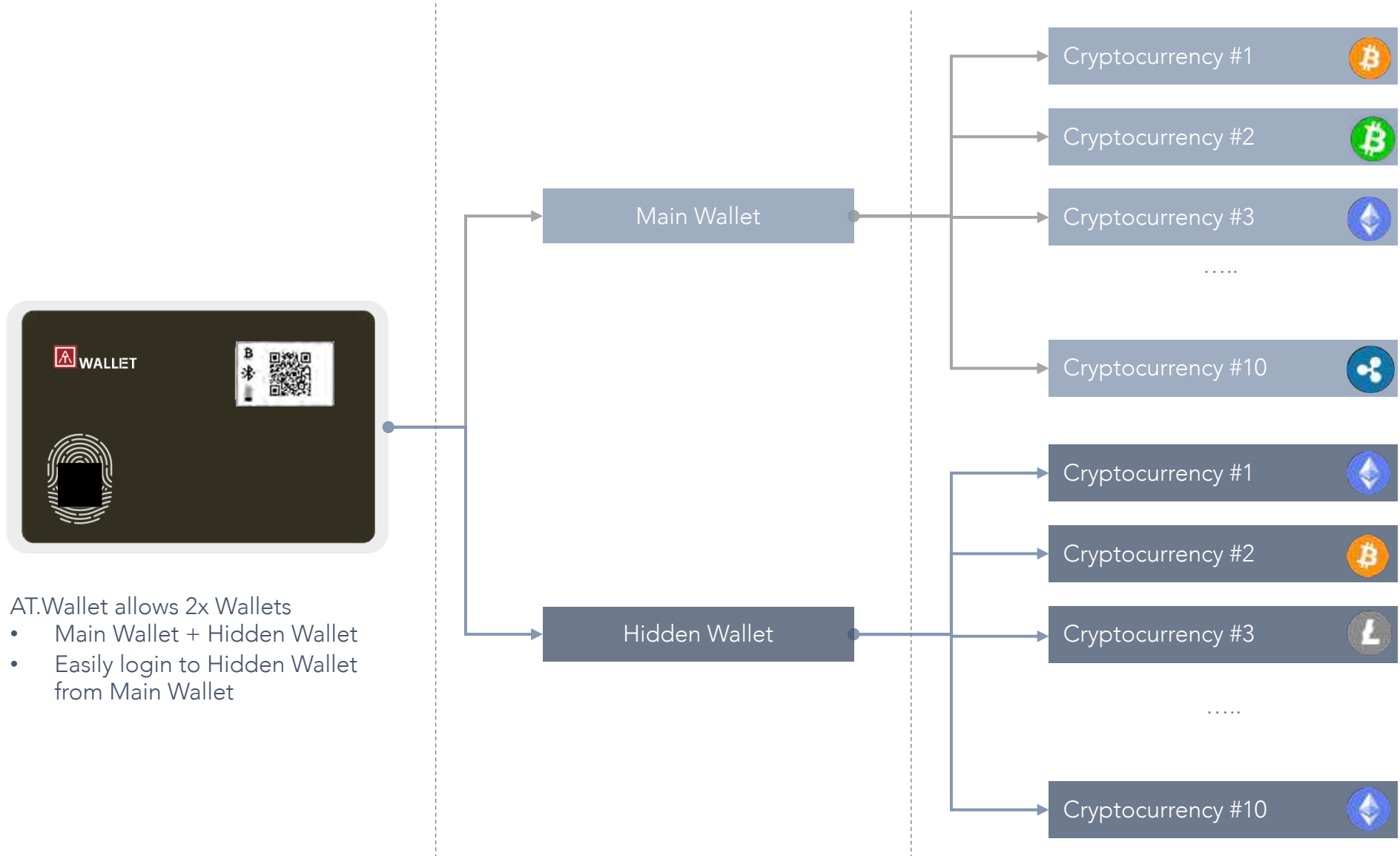

- AT.Wallet allows 2x Wallets
- Main Wallet + Hidden Wallet
 - Easily login to Hidden Wallet from Main Wallet

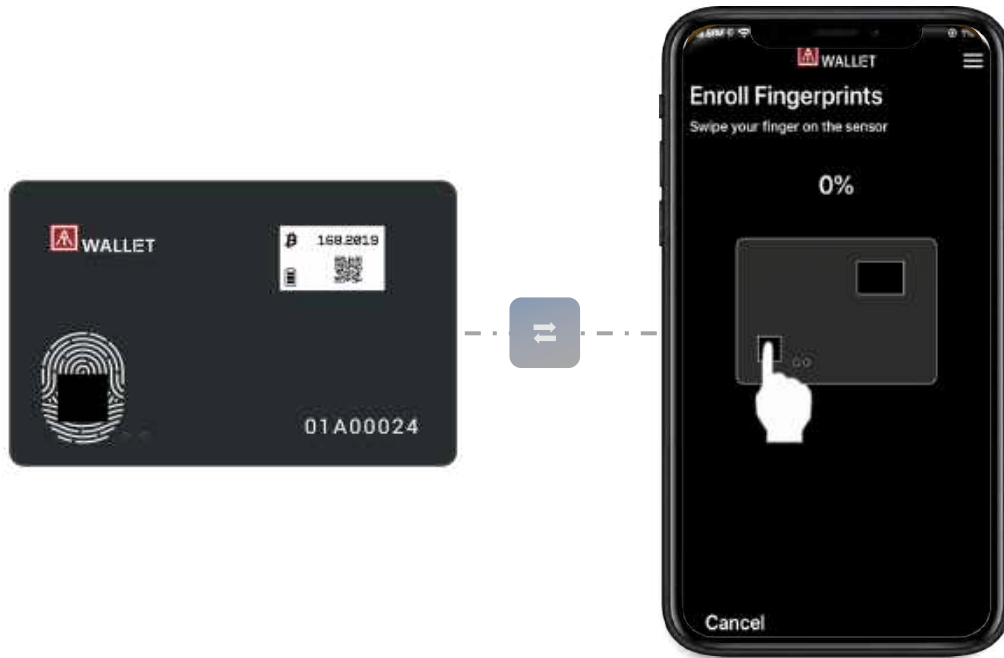
NOTE:

- If AT.Wallet connects to USB port but nothing happens (no LED ON), please wait for a while since there is the protect circuit to make sure the battery voltage is not lower than 3.0V.
- USB port of PC: USB mode- AT.Wallet can work as USB Wallet with Windows and Mac app
- USB power adaptor: BLE mode- AT.Wallet can work as BLE Wallet with iOS, Android, Windows and Mac app



Charge your AT.Wallet before the first use.

- 1) Insert your card into the docking to connect to USB port or any USB adaptor.
- 2) Download The App- AT.Wallet App

- Mobile



AT.Wallet App



- Desktop



<https://apps.apple.com/us/app/at-wallet/id1490097962?mt=12>

Or search "AT.Wallet"



A. Insert Your Wallet into Docking: YouTube - <https://youtu.be/mSfReGrRFWg>



B. Connect to PC 

→ USB icon will appear

→ LED#2 will be yellow flashing (charging process begins)





BLE (Bluetooth Low Energy)

Pair and connect via BLE: Working with the mobile app and the Windows/Mac app.



USB

Stay on Docking via USB to connect with PC by Windows/Mac app.



Standalone mode

Standalone mode to check amount and receive transaction via QR code.



More cryptocurrencies will be soon supported ...



Initial Wallet



1-1. BLE Pairing
1-2. USB Connection
(Mac /Windows app)



2. Enroll Fingerprint
& Matching



3-1. Create a New
Wallet
3-2. Recover your
Old Wallet



4-1. Add
Cryptocurrencies
4-2. Select a
cryptocurrency &
Synchronizations



5. Transaction(s) or
Settings



Login to AT.Wallet for Target Actions



1-1. BLE Connection
1-2. USB Connection
(Mac /Windows app)



2. Fingerprint
Matching



3. Cryptocurrency
Synchronization



4. Transaction(s)
Send/Receive

Settings

- Initial Hidden Wallet
(create new or recover wallet)
- Switch to Hidden Wallet
- Enroll/Delete Fingerprint(s)
- Add/Delete Cryptocurrency
- Log Out
- Reset
- Select Currency



Landing

Home Page



The Keycode appears on AT.Wallet matches the number shown on the app



Wallet Name

Total amount of this wallet; Default currency is following the region of the host device (mobile, PC)



ATWallet App



Menu Bar

Battery Status of Wallet Card
Back to Home Page
Shortcuts for Each Currency

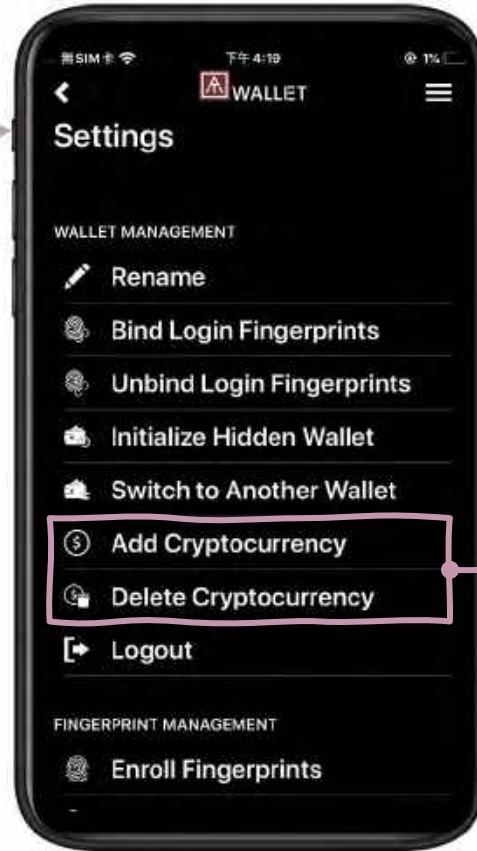

Setting

You can add new cryptocurrency here;
If you want to enable BIP84 for Bitcoin or Litecoin, here is the only place to enable.

You only can delete created cryptocurrency here.



AT Wallet App



Initial Wallet



If you can't find your device here, clear the device from your phone's memory and pair again.

- 1-1. BLE Pairing
- 1-2. USB Connection (Mac /Windows app)



1) Double-Click power button of AT.Wallet card to start Bluetooth secure pairing mode.



2) Click your AT.Wallet from above list, which the Keycode appears on AT.Wallet matches the number shown on the app.



3) LED#2 of Wallet card shows white flashing, touch fingerprint sensor to pair

5. Transaction / or Settings



Initial Wallet



- 1) Touch fingerprint sensor around 14~16 times.
- 2) Percentage of Enrollment is Increasing.
- 3) Verify enrolled fingerprint –
 - “Matched” (LED#2 shows **GREEN**);
 - If it’s “Mismatched” (LED shows **RED**), please touch again to verify.
- 4) Click “Enroll” to enroll more fingerprints in or click “Done” to finish.

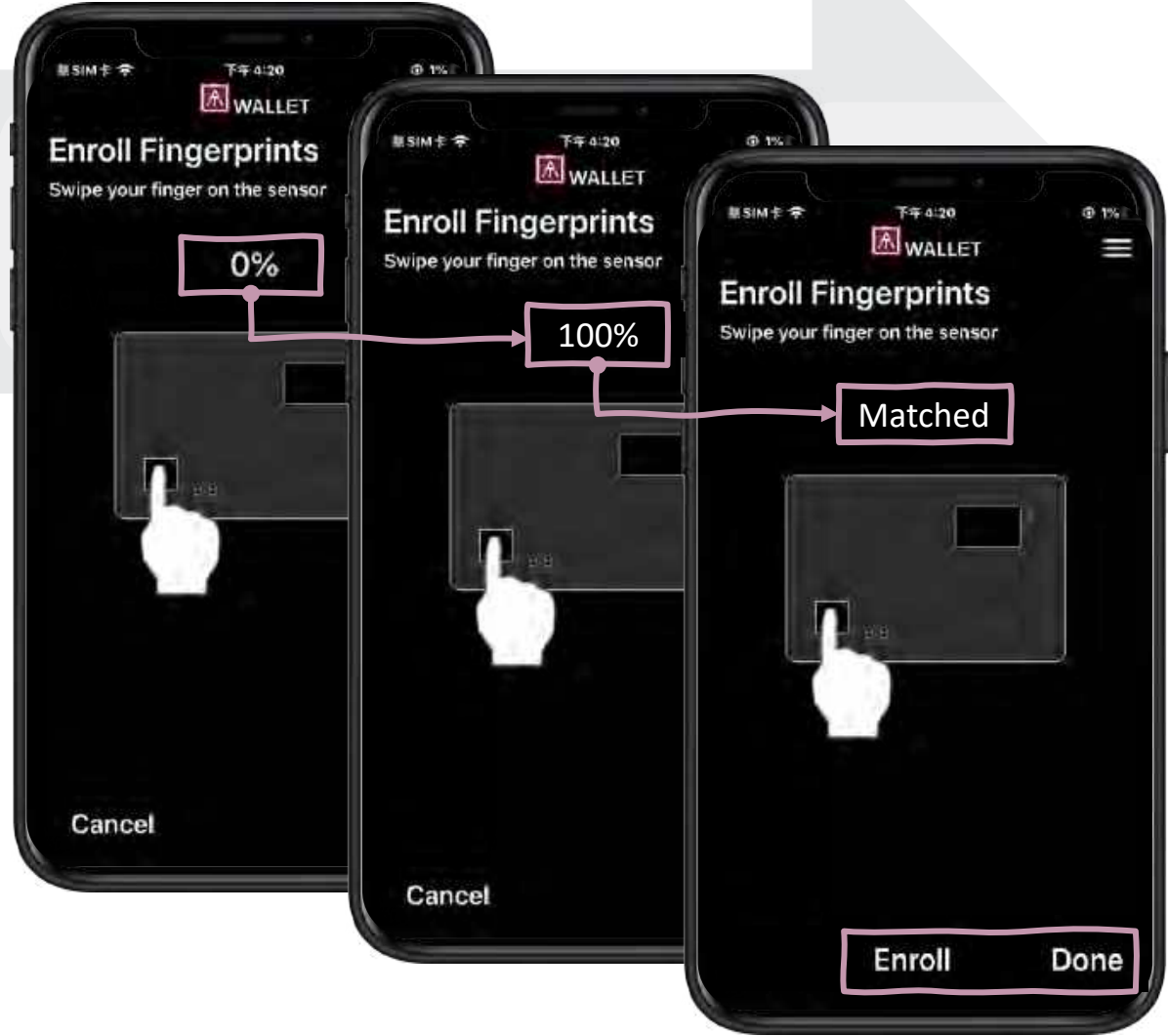



AT Wallet App



Initial Wallet

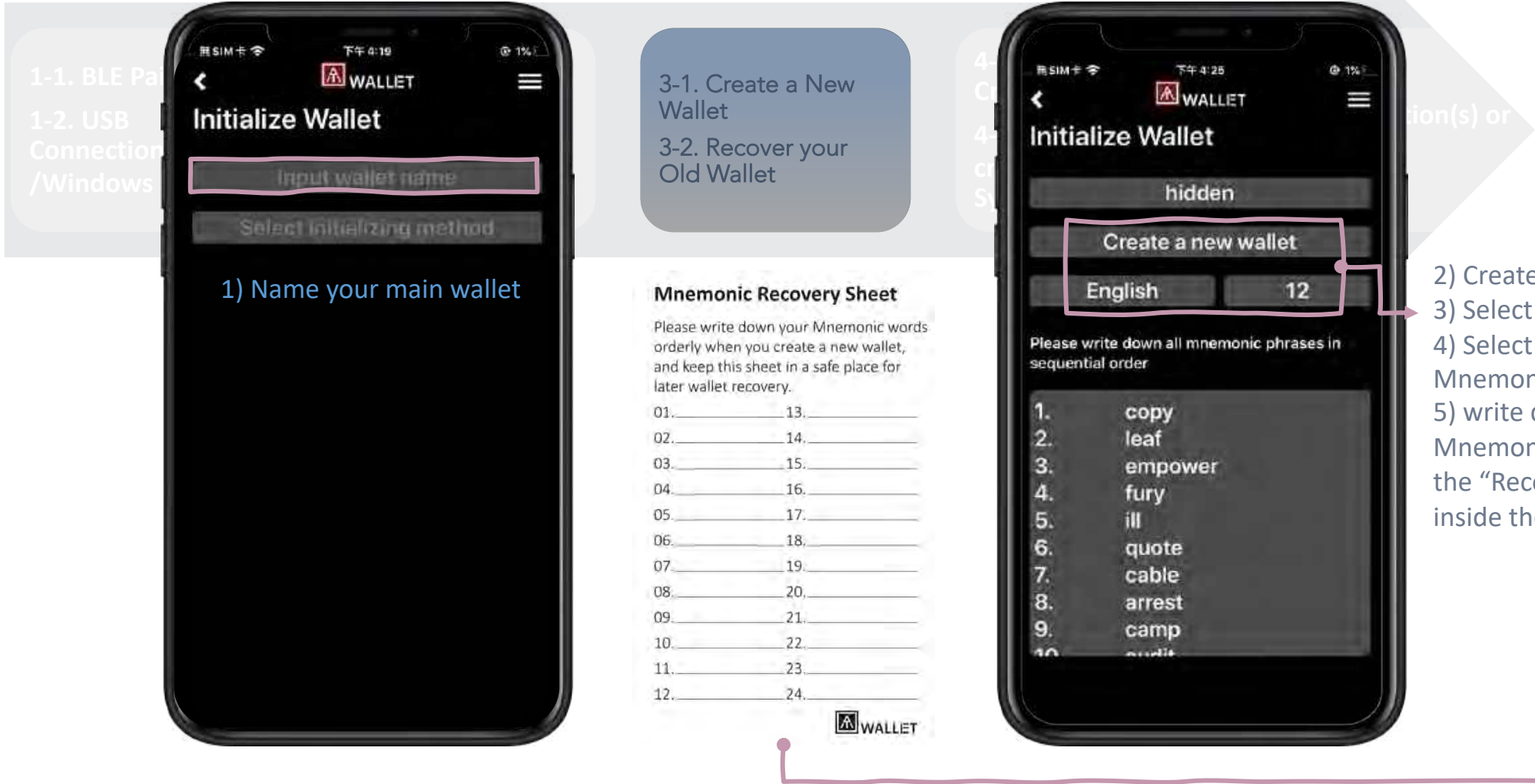



Initial Wallet

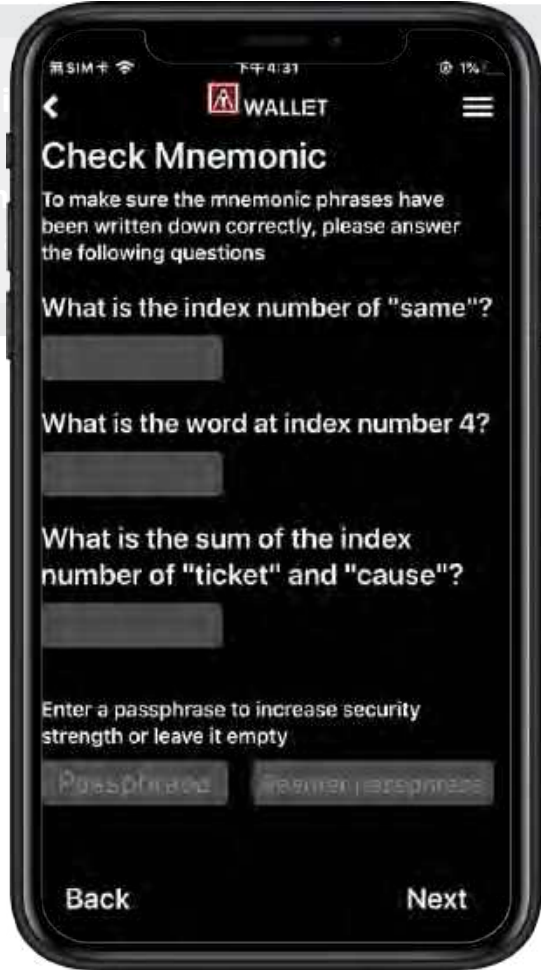
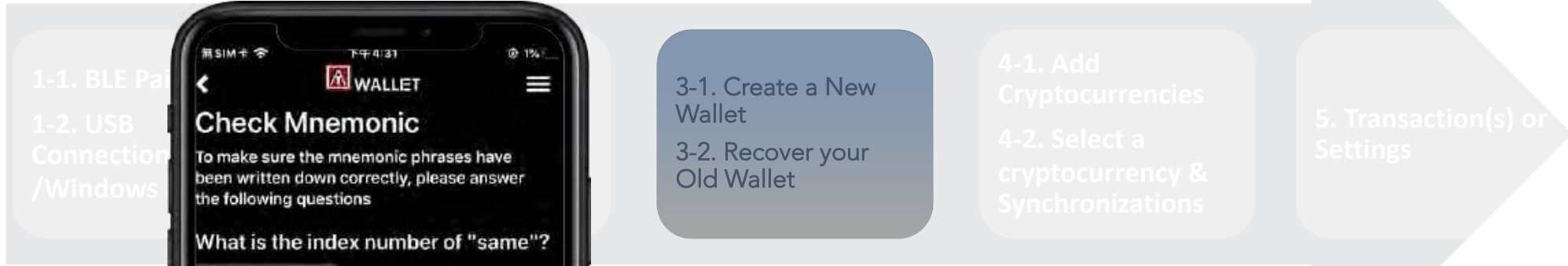

3-1. Create a New Wallet
3-2. Recover your Old Wallet

4-1. Add Cryptocurrencies
4-2. Select a cryptocurrency & Synchronizations

5. Transaction(s) or Settings

Mnemonic Recovery Sheet

Please write down your Mnemonic words orderly when you create a new wallet, and keep this sheet in a safe place for later wallet recovery.

01. _____	13. _____
02. _____	14. _____
03. _____	15. _____
04. _____	16. _____
05. _____	17. _____
06. _____	18. _____
07. _____	19. _____
08. _____	20. _____
09. _____	21. _____
10. _____	22. _____
11. _____	23. _____
12. _____	24. _____



- 1) Answer questionnaires following the “Recovery Sheet” that you wrote down.
- 2) (option) For better security, you can assign “Passphrase” for those “Mnemonic words” for recovery, so that when you do “recover wallet base on Mnemonic words”, it requires you to type correct “Passphrase” to recover. Please remember your Passphrase, we won’t record it!

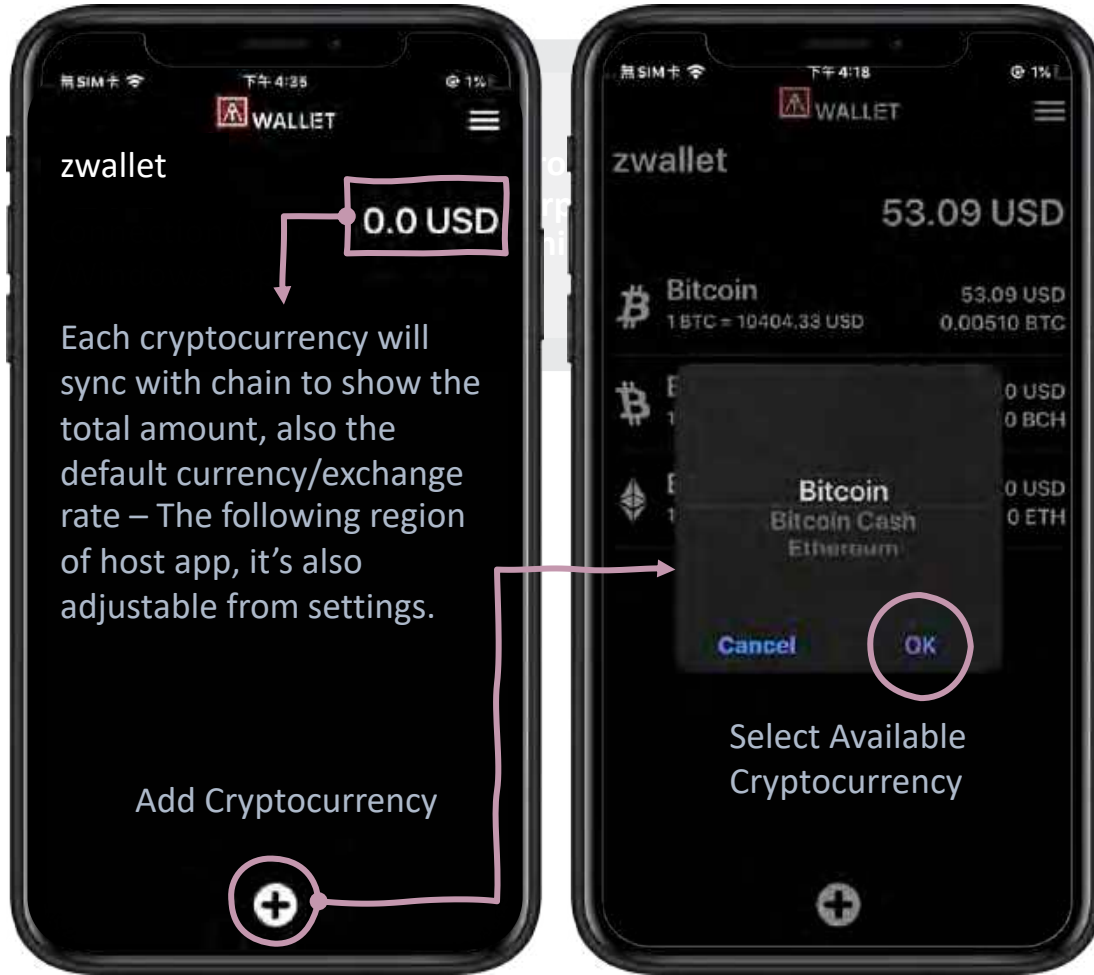

Each cryptocurrency will sync with chain to show the total amount, also the default currency/exchange rate – The following region of host app, it's also adjustable from settings.

4-1. Add Cryptocurrencies
4-2. Select a cryptocurrency & Synchronizations

5. Transaction(s) or Settings

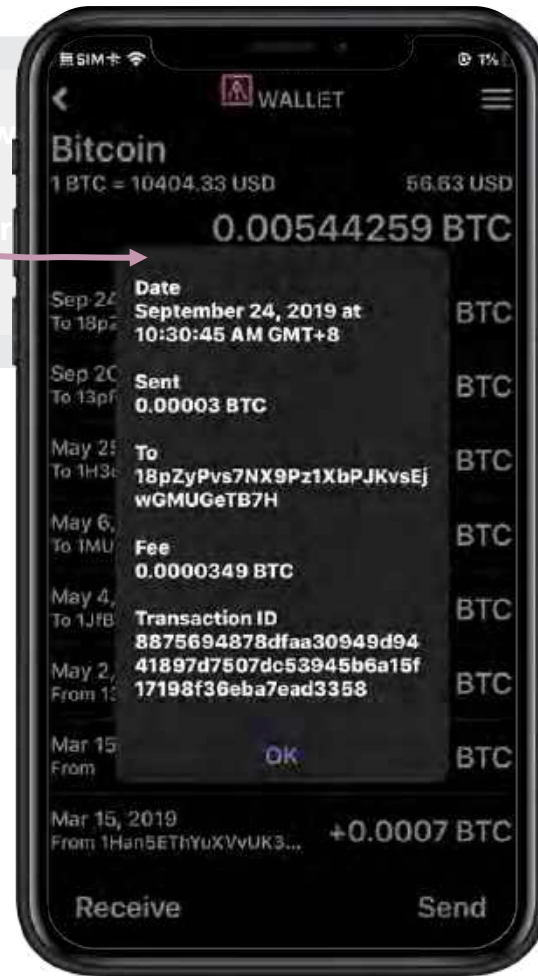

5. Transaction(s) or Settings

Transaction Records

Transaction Details

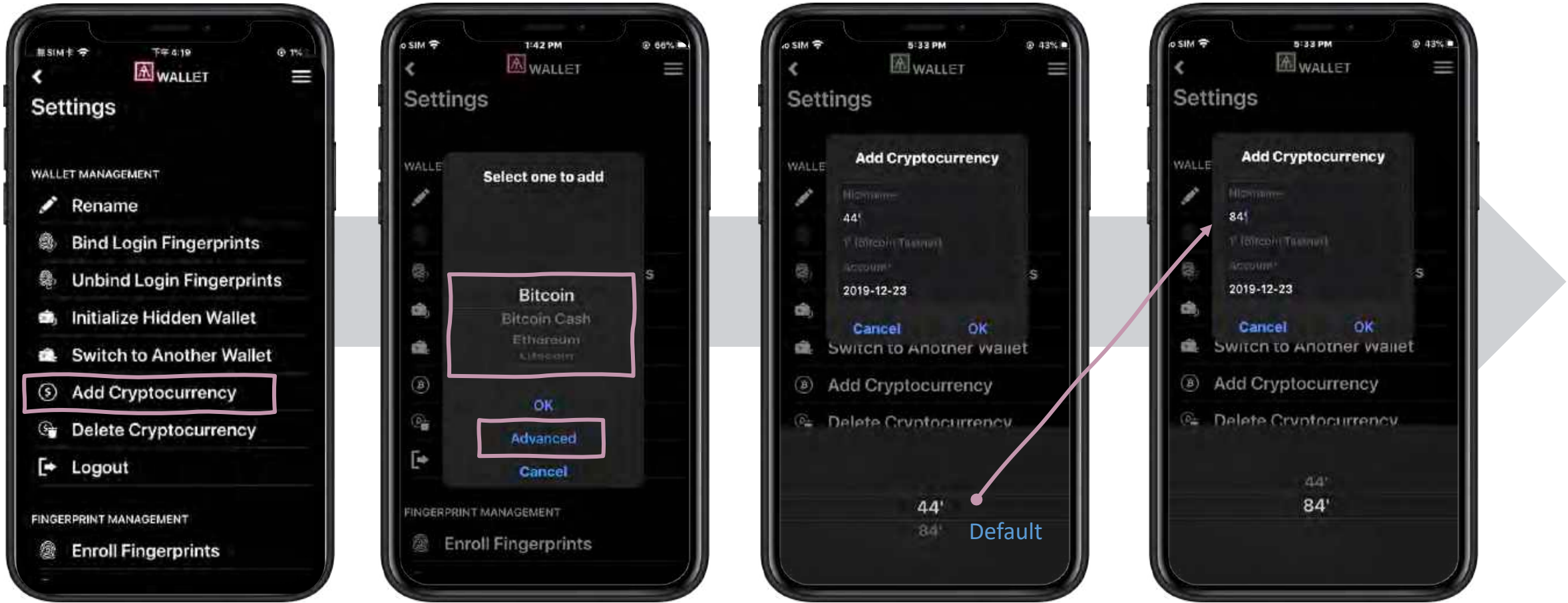

BIP44 refers to the accepted common standard to derive non Segwit addresses. These addresses always begin with a 1. (default of AT.Wallet)

BIP84 refers to the accepted common standard of deriving native segwit addresses. These addresses always begin with bc1 - and are referred to bech32 addresses.

- You can switch to BIP84 when you are adding new cryptocurrency (Bitcoin or LiteCoin only) as below.



What's Segwit?
[Learn more details!](#)



For others to send coins to you



Select your choice and click "Receive" button.

Showing QR code and address.

select the address and present QR code for scan or copy the address to share manually.

5. Transaction(s) or Settings

* Fingerprint verification is NOT necessary for receiving payments.



Send coins to others simply



Filling in the "To" line with the address or press the icon to scan receiver's QR code.

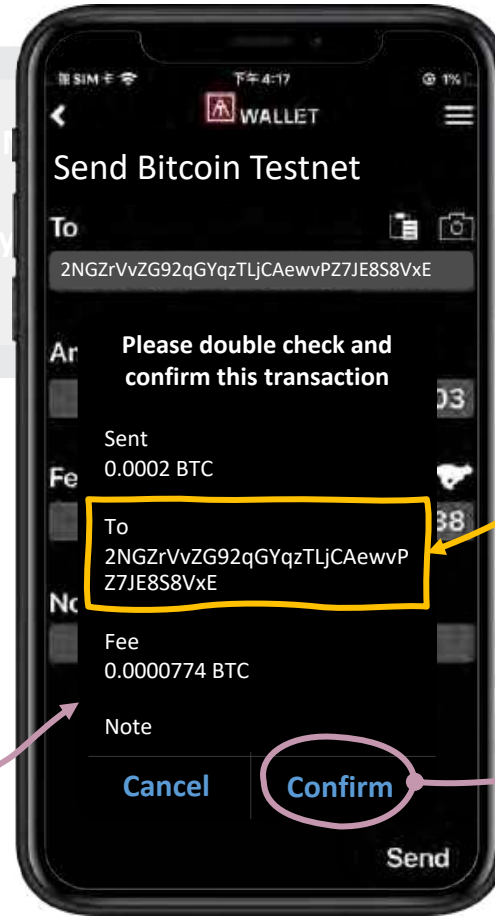

Check the sending details on the app, as well as your card. Make sure the amount on both screens is correct.

5. Transaction(s) or Settings



Verify by bound fingerprint(s) or verify by any enrolled fingerprint if there is no binding.

1x AT.Wallet card

→ 2x Wallet(s) per card

→ 10x Cryptocurrencies per wallet



- AT.Wallet allows 2x Wallets
- Main Wallet + Hidden Wallet
 - Easily login to Hidden Wallet from Main Wallet





- Up to 8x fingers
- The fingerprint can't be deleted only if it's bound with assigned wallet.
- If there is something wrong with your fingerprint sensor, re-calibrate sensor to work (Please do not touch fingerprint sensor during calibration!)

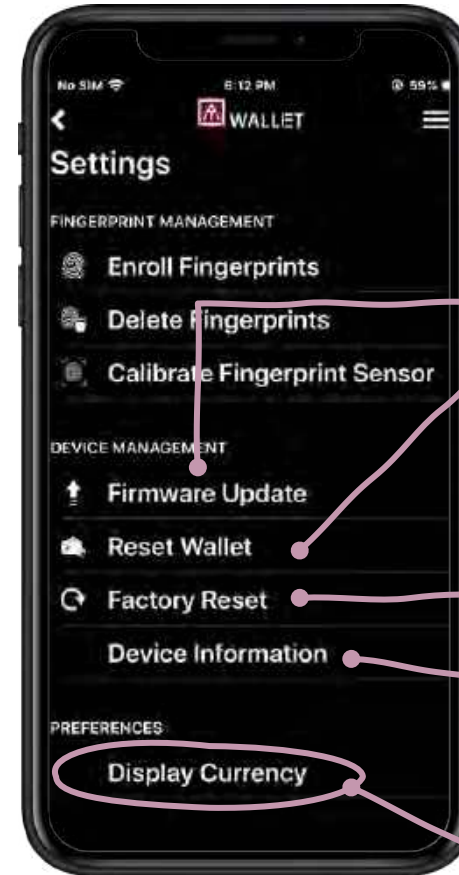

- Check and upgrade firmware automatically.
- If you lose your wallets, you can recover it and enrolled fingerprints will still be there.
- Erase all data.
- AT.Wallet card ID, Firmware version, battery status.
- Select currency.



- If there is no any fingerprint bound with specific wallet:
 - 1) Login to main wallet via any enrolled fingerprint.
 - 2) Switch to hidden wallet from main wallet.
 - 3) Standalone mode is only for main wallet.

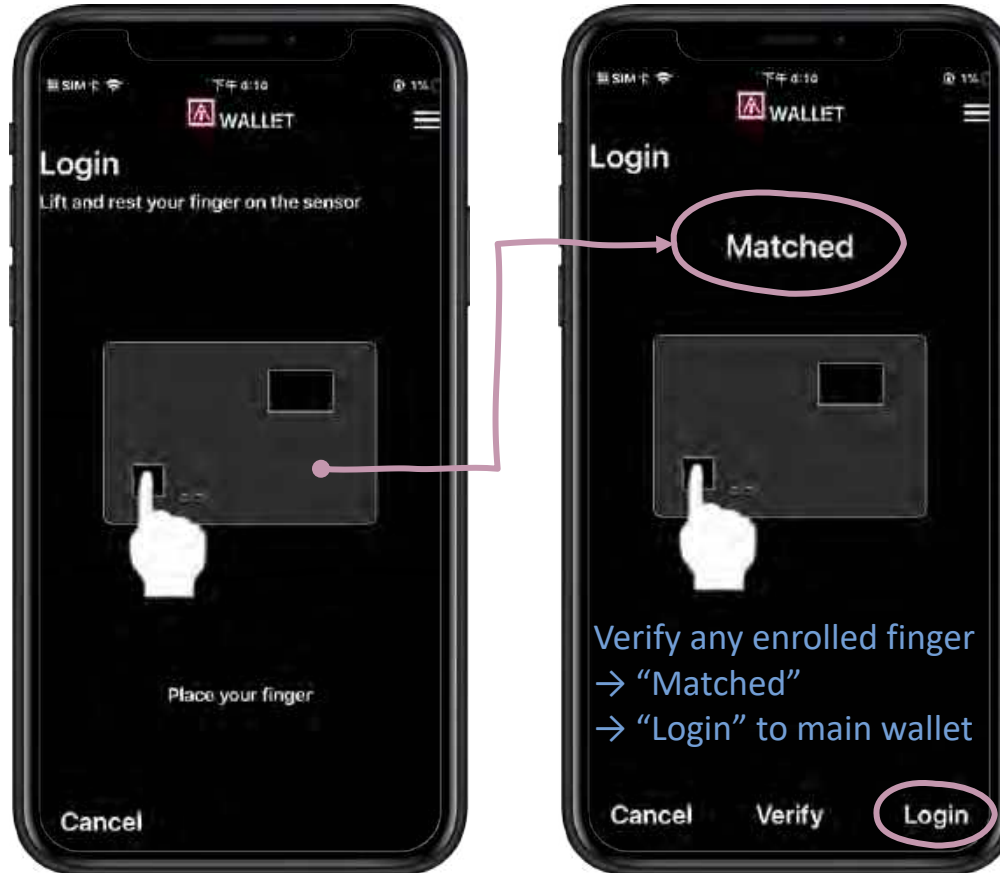

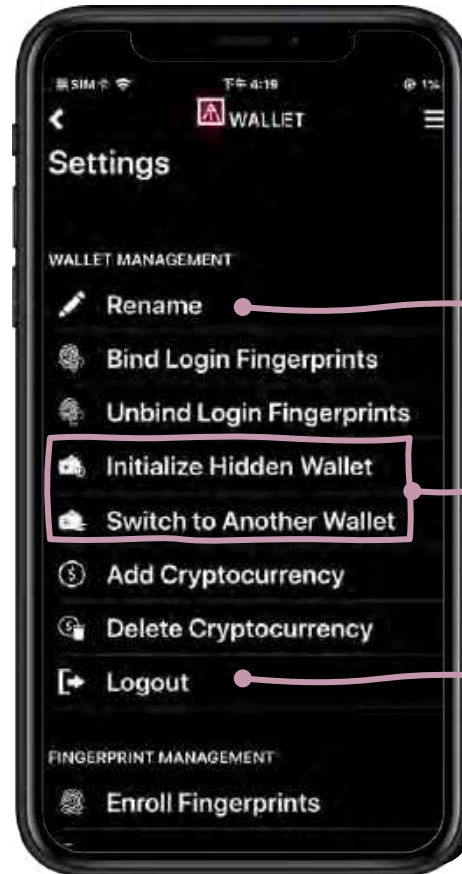

- Rename wallet (main or hidden wallet) or Cryptocurrency.
- Initiate and Login to hidden wallet from "Switch to Another Wallet".
- Logout from AT.Wallet, BLE disconnected; If your wallet card is power off, please logout from here and re-login.

- Firmware Update

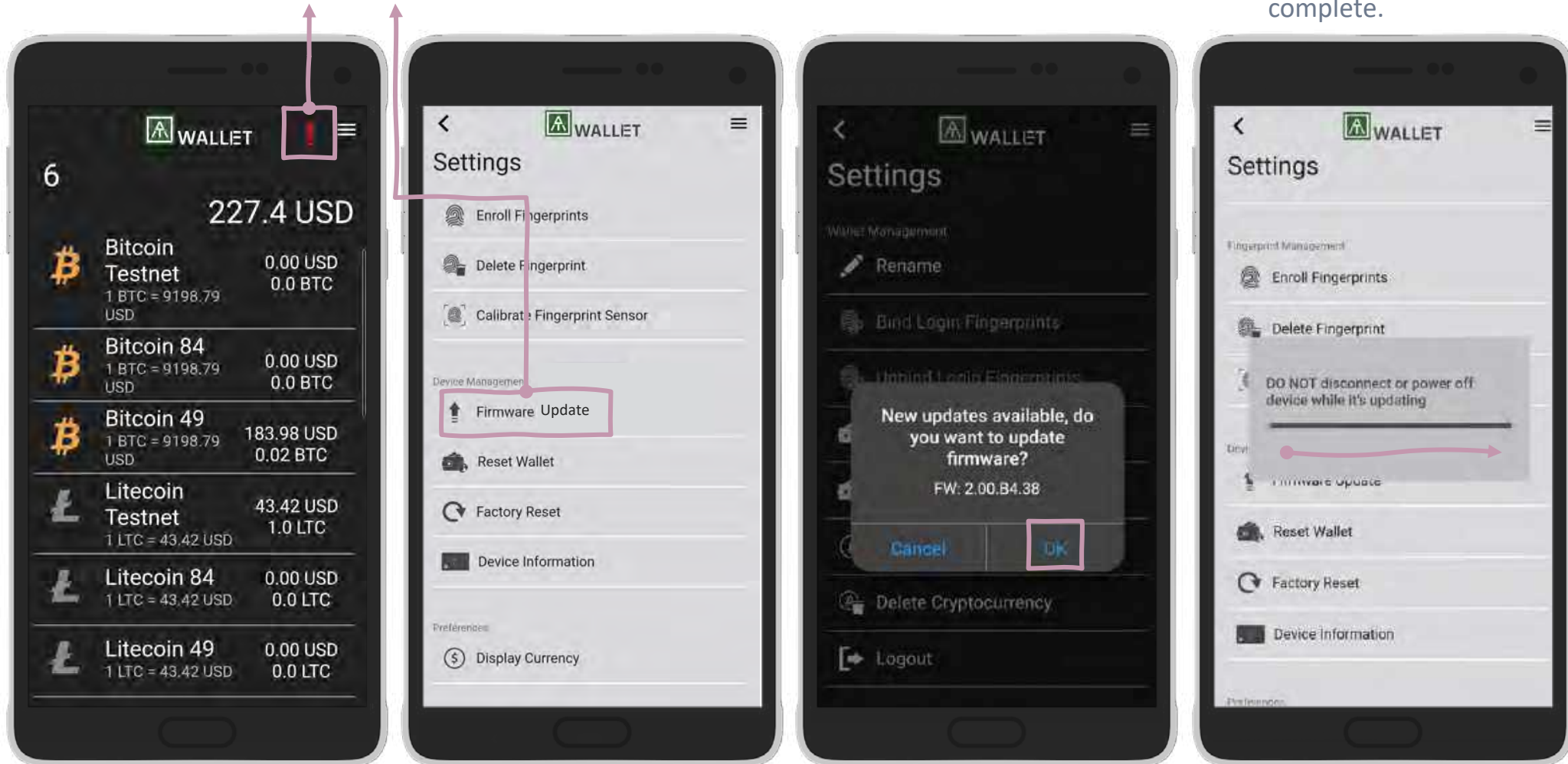

- The power cannot be turned off until the software update is complete.



Landing

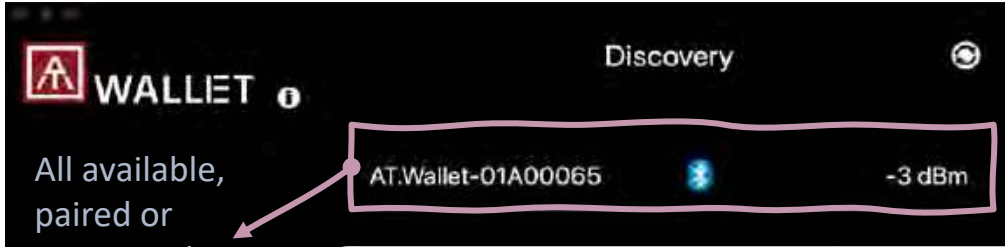

All available, paired or connected AT.Wallet cards.

Home Page

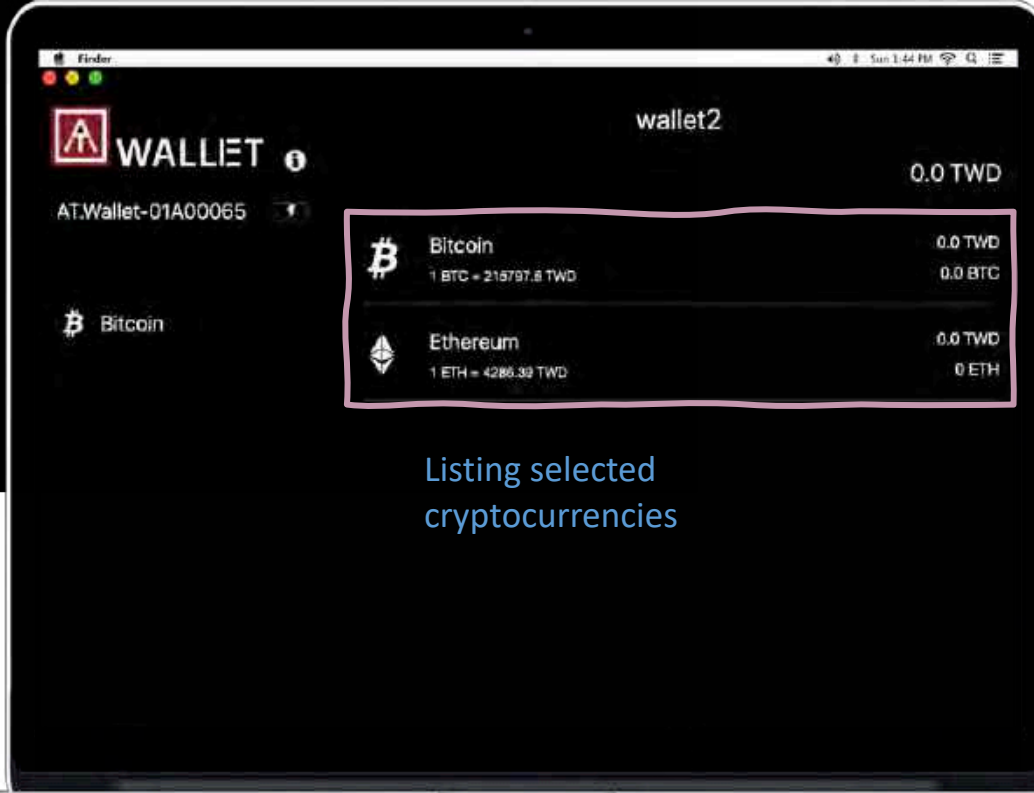

Listing selected cryptocurrencies

Settings

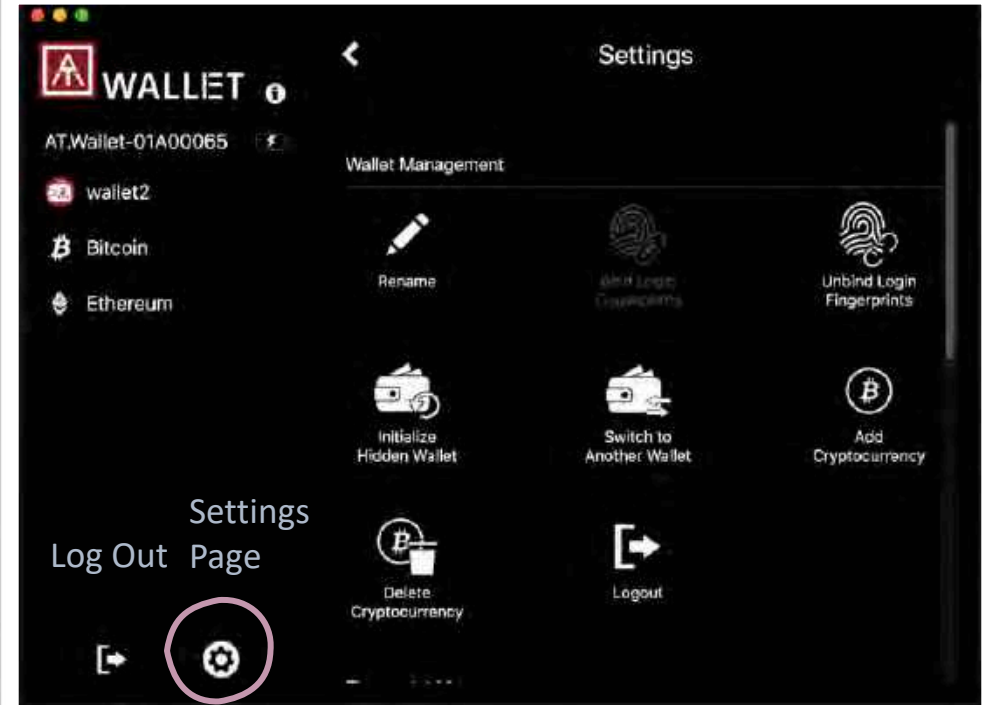

Settings Log Out Page



AT.Wallet App



BLE Pairing



USB Connecting

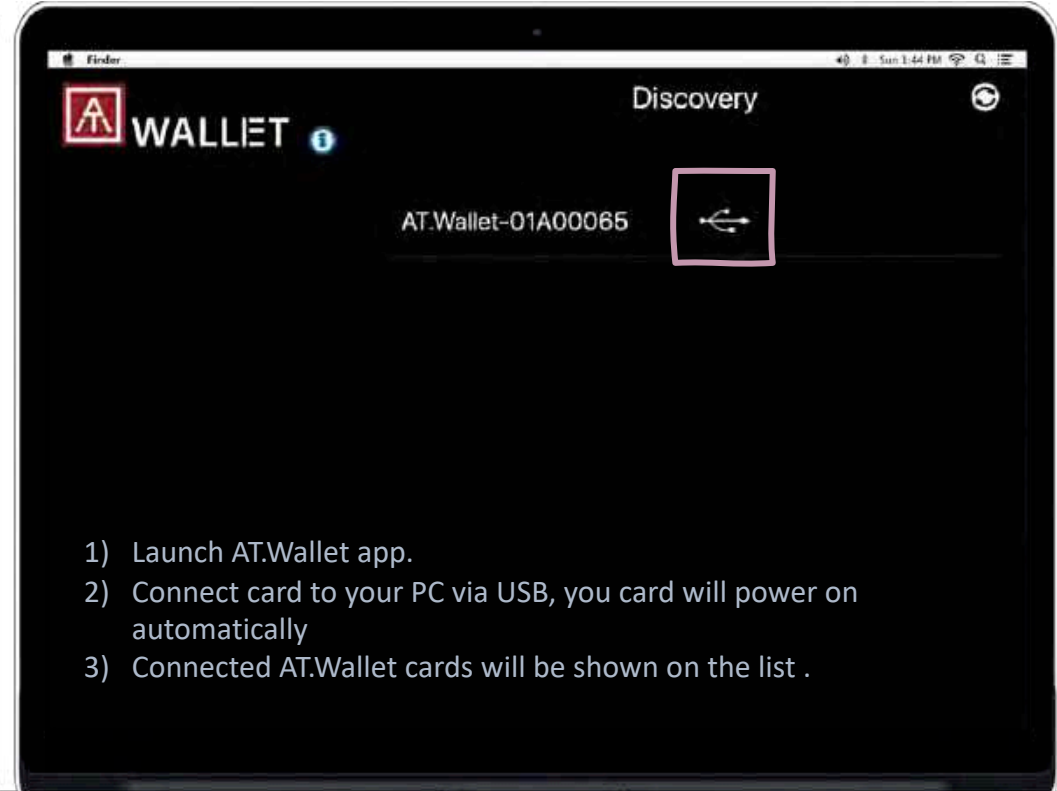
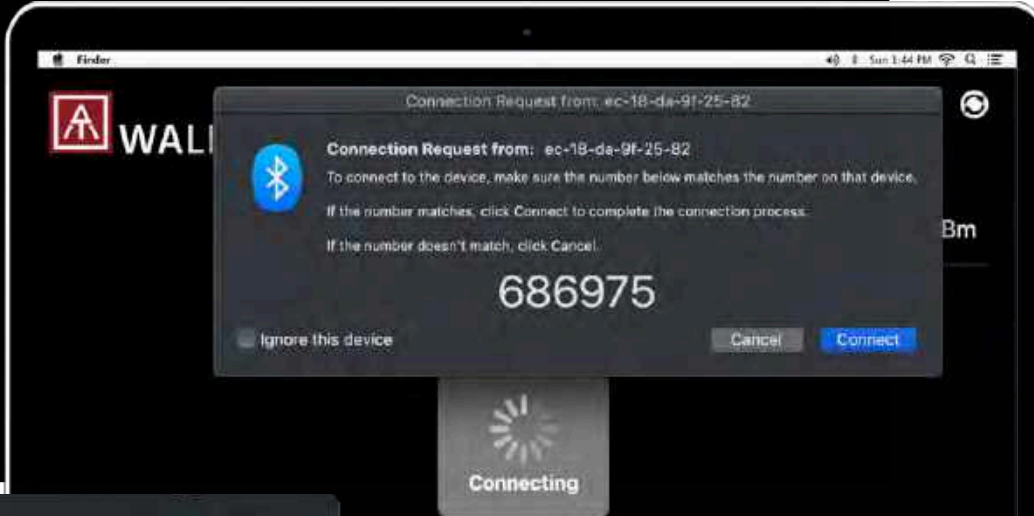
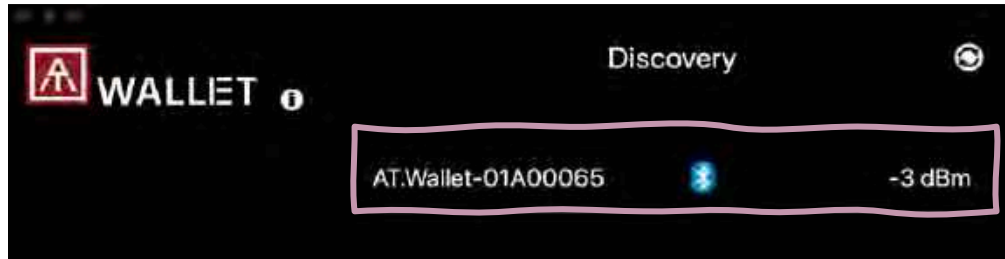

- 1) Launch AT.Wallet app and turn Bluetooth ON.
- 2) Power on your AT.Wallet.
- 3) Identify your card by Keyword.
- 4) LED#2 is white flashing - Touch fingerprint sensor to confirm pairing.
- 5) "Connect".

- 1) Launch AT.Wallet app.
- 2) Connect card to your PC via USB, you card will power on automatically
- 3) Connected AT.Wallet cards will be shown on the list .

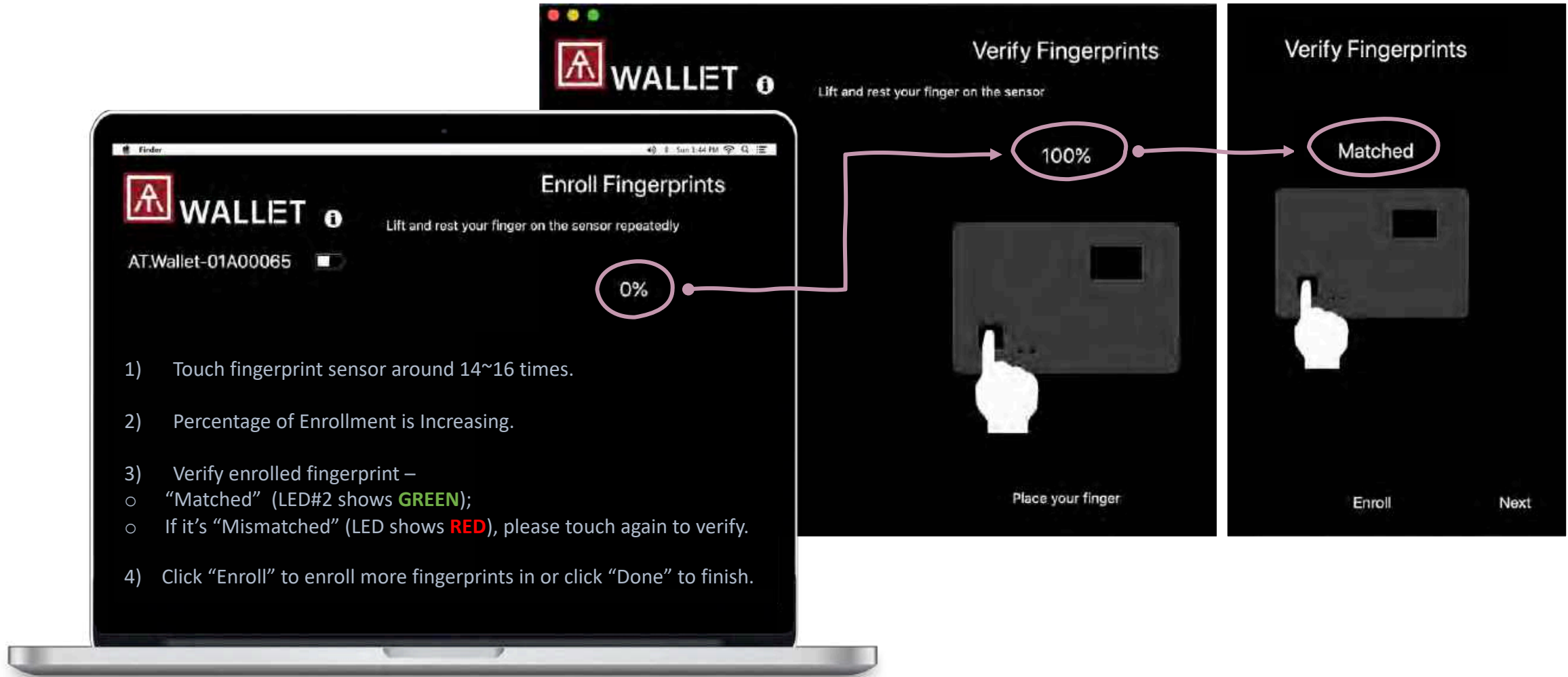

The image illustrates the fingerprint enrollment process. On the left, a laptop screen displays the 'Enroll Fingerprints' screen with a progress indicator at 0%. Below the screen, a list of instructions is provided. On the right, two tablet screens show the 'Verify Fingerprints' process. The first tablet screen shows a progress indicator at 100% and a hand placing a finger on the sensor. The second tablet screen shows a progress indicator at 'Matched' and a hand resting on the sensor. Arrows connect the 0% indicator on the laptop to the 100% indicator on the first tablet, and from the 100% indicator to the 'Matched' indicator on the second tablet.

Enroll Fingerprints
Lift and rest your finger on the sensor repeatedly

AT.Wallet-01A00065

0%

- 1) Touch fingerprint sensor around 14~16 times.
- 2) Percentage of Enrollment is Increasing.
- 3) Verify enrolled fingerprint –
 - “Matched” (LED#2 shows **GREEN**);
 - If it’s “Mismatched” (LED shows **RED**), please touch again to verify.
- 4) Click “Enroll” to enroll more fingerprints in or click “Done” to finish.

Verify Fingerprints
Lift and rest your finger on the sensor

100%

Place your finger

Verify Fingerprints

Matched

Enroll Next



- 1) Verify enrolled fingerprint –
 - “Matched” (LED#2 shows **GREEN**);
 - If it’s “Mismatched” (LED shows **RED**), please touch again to verify.

- 2) Click “Login” to initial wallet.

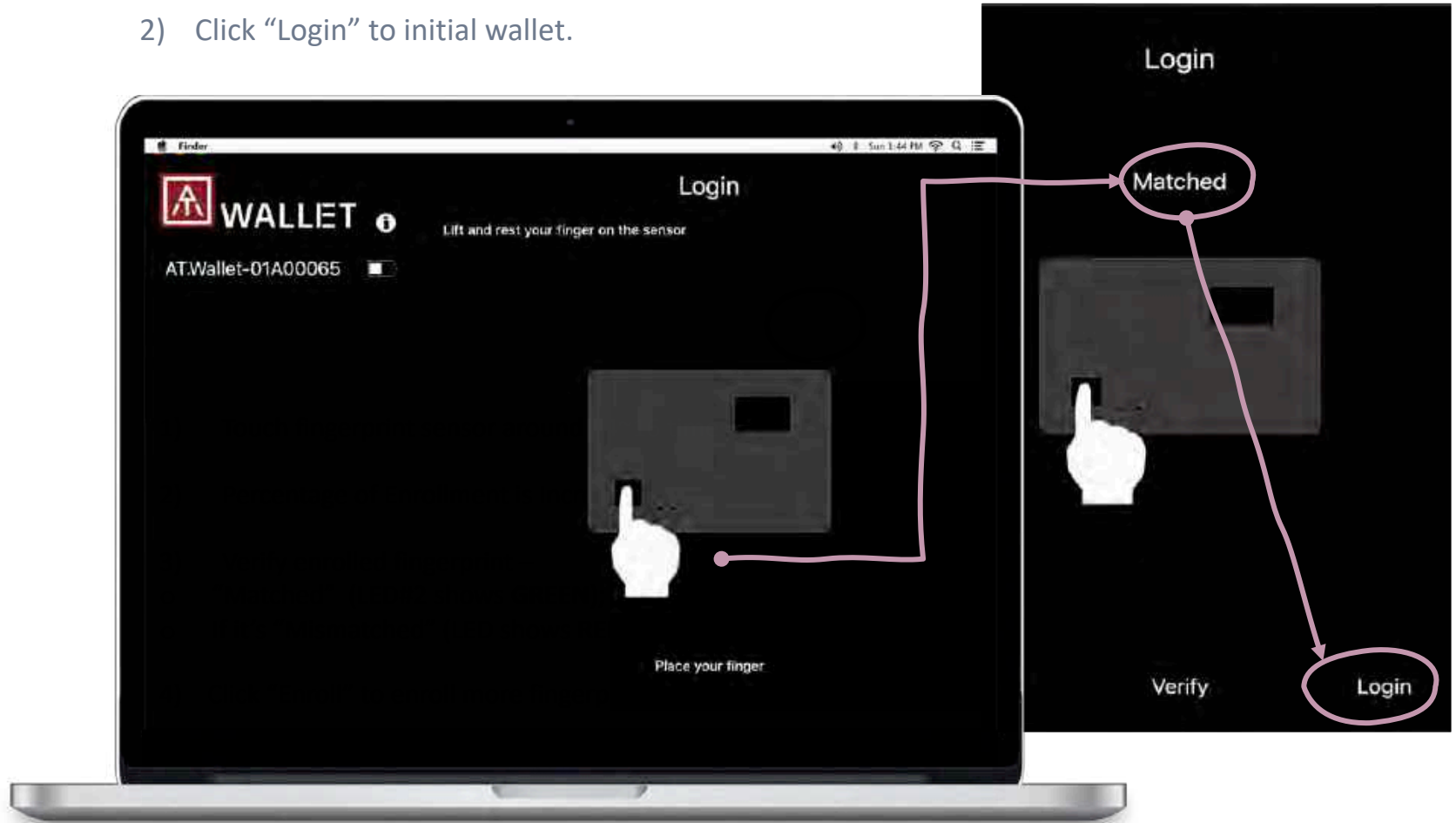



- 3) Create a new wallet
- 4) Select language
- 5) Select length of Mnemonic.





6) write down Mnemonic words to the "Recovery Sheet" inside the box.

Mnemonic Recovery Sheet

Please write down your Mnemonic words orderly when you create a new wallet, and keep this sheet in a safe place for later wallet recovery.

- 01. _____ 13. _____
- 02. _____ 14. _____
- 03. _____ 15. _____
- 04. _____ 16. _____

7) Answer questionnaires following the "Recovery Sheet" that you wrote down.

8) (option) For better security, you can assign "Passphrase" for those "Mnemonic words" for recovery. Please remember your Passphrase, we won't record it!

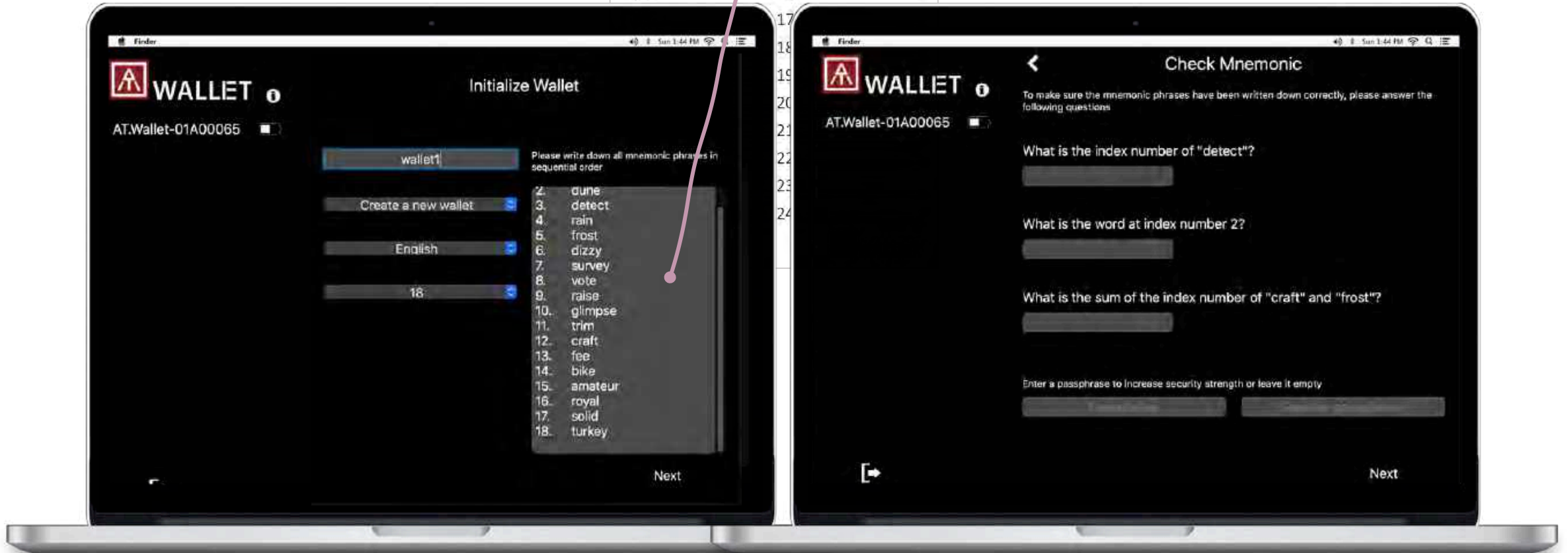



Each cryptocurrency will sync with chain to show the total amount, also the default currency/exchange rate – The following region of host app, it's also adjustable from settings.

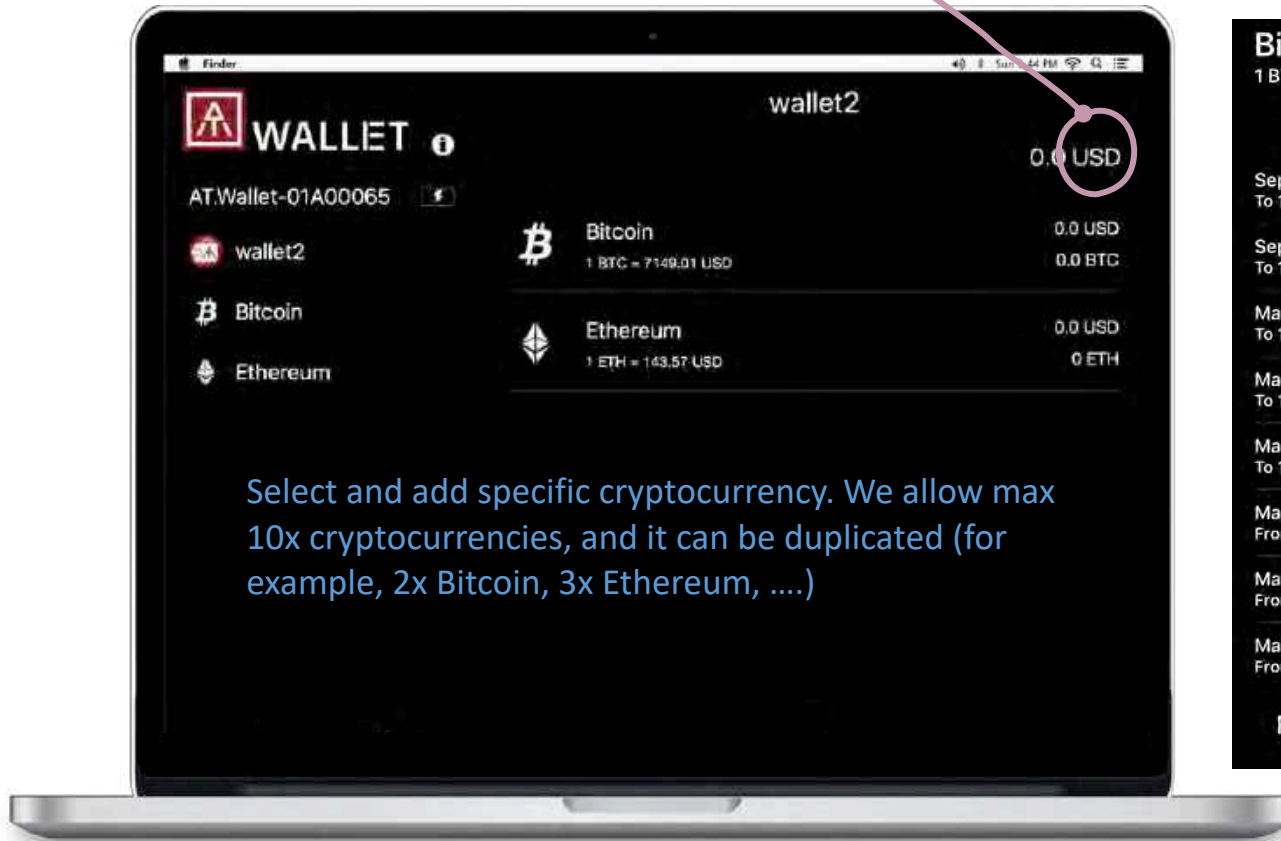

Transaction Records



Transaction Details





For others to send coins to you

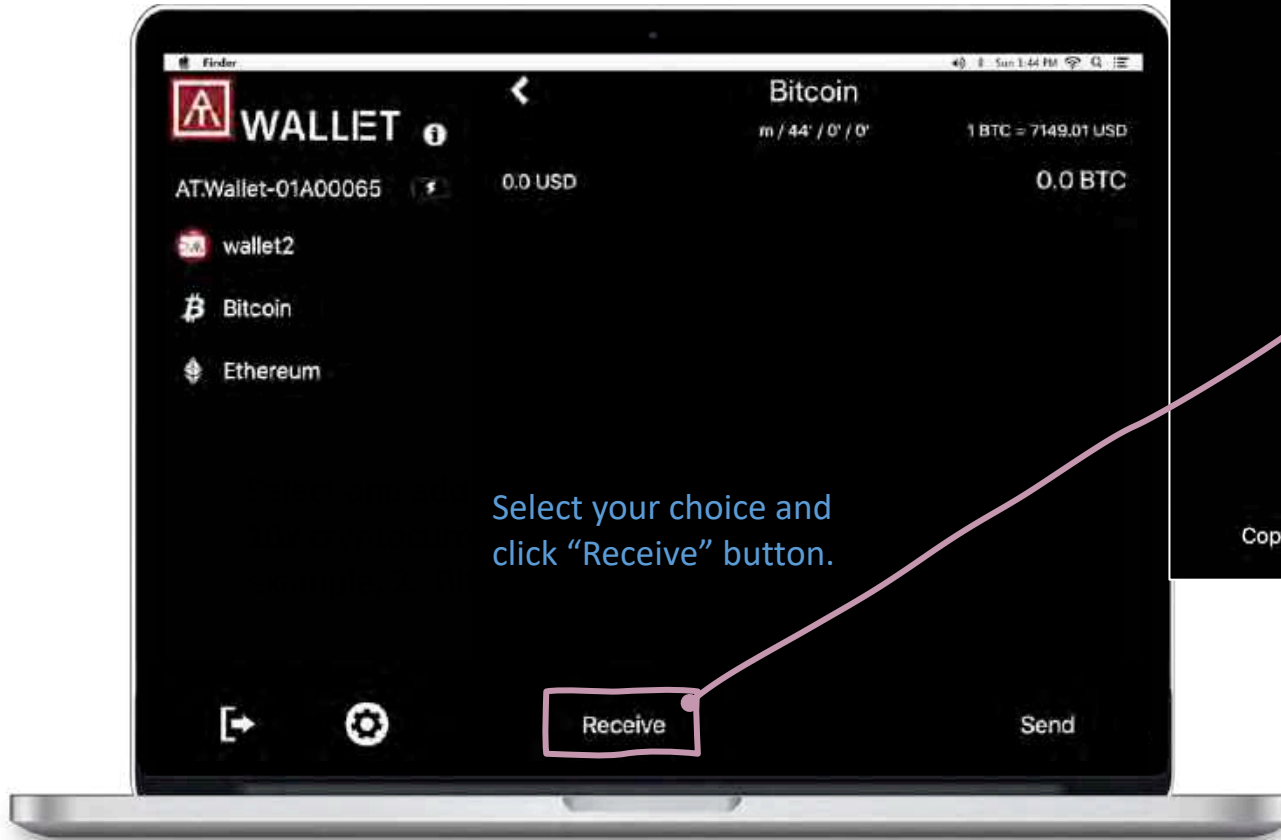

Select your choice and click "Receive" button.



Showing QR code and address.



select the address and present QR code for scan or copy the address to share manually.

* Fingerprint verification is NOT necessary for receiving payments.



Send coins to others

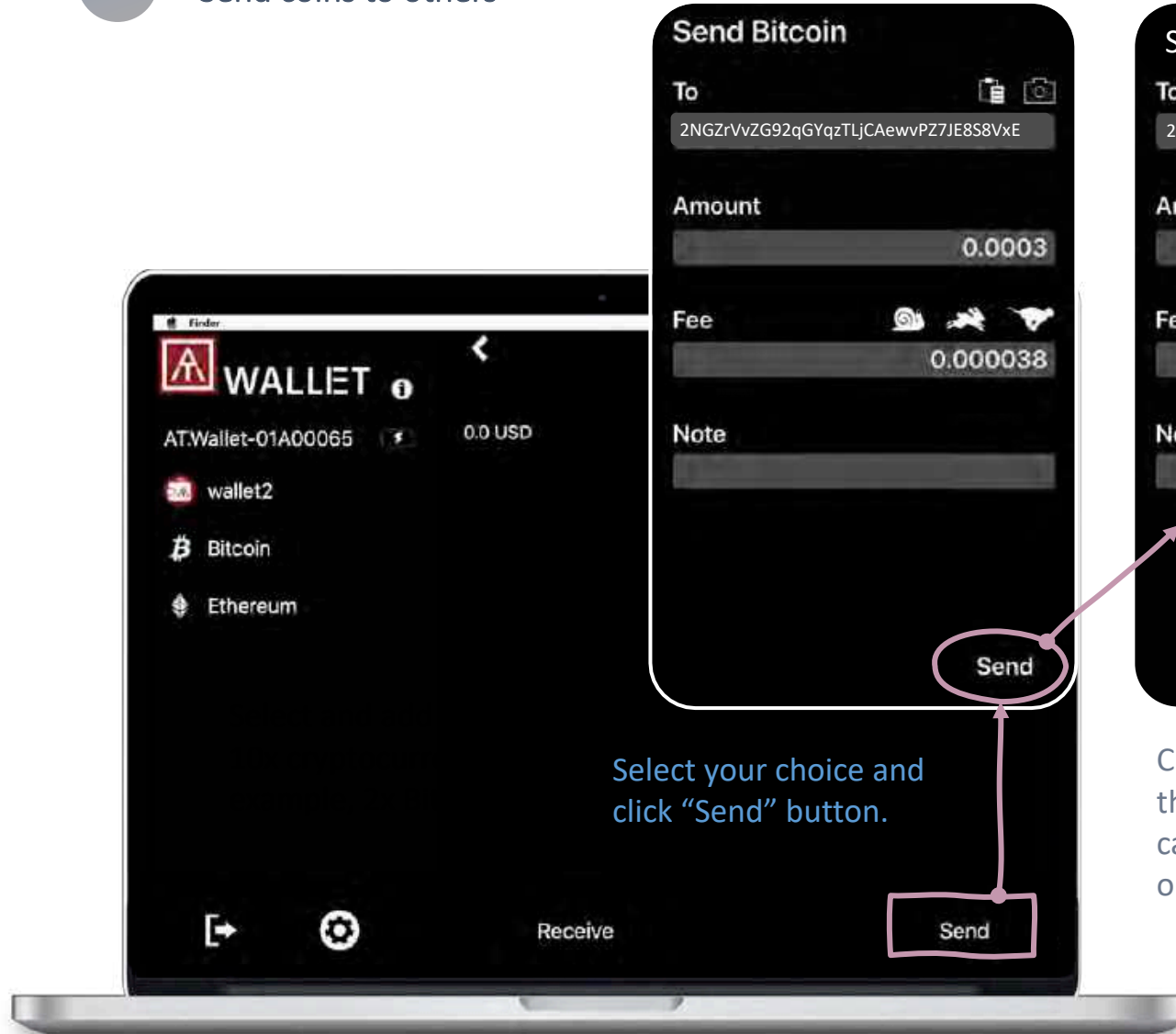

Select your choice and click "Send" button.

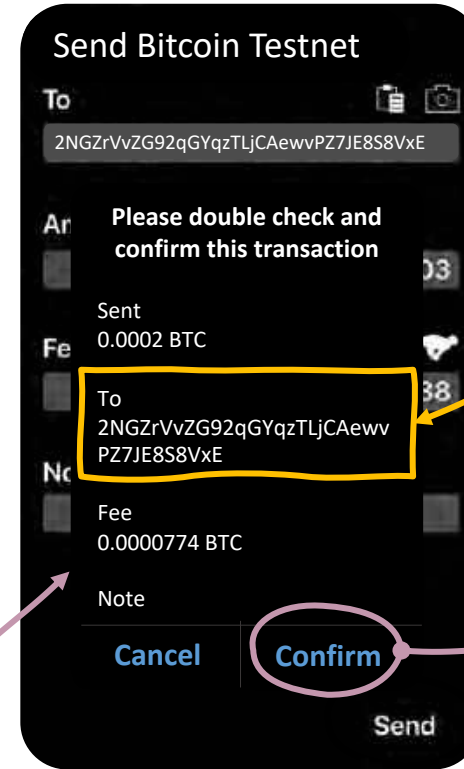

Check the sending details on the app, as well as your card. Make sure the amount on both screens is correct.



Verify by bound fingerprint(s) or verify by any enrolled fingerprint if there is no binding.



AT Wallet App

Settings**Wallet Management**

- Add Cryptocurrency: You can add new cryptocurrency here; If you want to enable BIP84 for Bitcoin or Litecoin, here is the only place to enable.
- Delete Cryptocurrency: you only can delete created cryptocurrency here
- Rename: Rename wallet (main or hidden wallet) or Cryptocurrency.
- Switch to Another Wallet: Initiate and Login to hidden wallet from "Switch to Another Wallet".
- Logout from AT.Wallet, BLE disconnected; If your wallet card is power off, please logout from here and re-login.

Fingerprint Management

- Enroll Fingerprints: Up to 8x fingers.
- Delete Fingerprints: The fingerprint can't be deleted only if it bound with assigned wallet.
- Calibrate Fingerprint: If there is something wrong with your fingerprint sensor, re-calibrate sensor to work. (Please do not touch fingerprint sensor during calibration!)

Device Management

- Firmware Update: Check and upgrade firmware automatically.
- If you lose your wallets, you can recover it and enrolled fingerprints will still be there.
- Factory Reset: Erase all data.
- Display Currency: Select currency.



Power ON



Verify Assigned Fingerprint to Login to Main Wallet



Fingerprint Matched



Loading ...

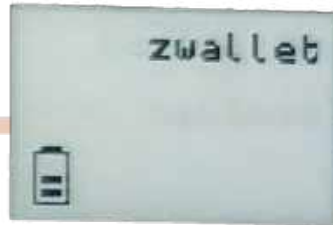

Name of Main wallet



1st Cryptocurrency Summary



1st Cryptocurrency QR Code for Receiving

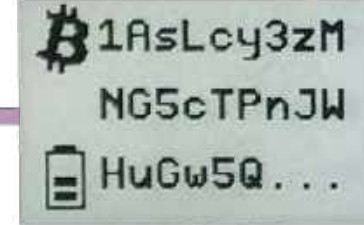

1st Cryptocurrency Address for Receiving



2nd Cryptocurrency Summary



Toggle power button to the next page continuously...



Note:
If there is no bound wallet, it will always support main wallet.

If you bound fingerprint for specific wallet, please verify by all bound finger to login.



- E-Ink: Icons + message (English and Japanese).
- Message language is following App “OS language” to show Japanese or English.

	LED#1	LED#2	E-Ink Icon & Message
Power ON	Static Blue	Blue flashing	BLE or USB – Battery – [Welcome]
BLE pairing mode	Static Blue	Cyan flashing	Battery – [message]
BLE pairing confirmation	Static Blue	White flashing	
BLE connected to host	Static Blue	Static Blue	
Waiting for fingerprint matching	Blue flashing	Blue	BLE or USB – Battery – [message]
Fingerprint matched	Blue	Green ON	BLE or USB – Battery – [message]
Fingerprint not matched	Blue	RED ON	BLE or USB – Battery – [message]
Battery charging	Blue	Yellow flashing	USB – Battery charging Battery charging
Low battery	Blue	RED flashing	Battery low
Battery charging till booting	N/A	RED flashing	No display

Battery Icon:

Level 3: Full (85%~100%)

Level 2: 61%~85%

Level 1: 36%~60%

 !: <35%, Low battery, and LED#2 is **RED flashing**
USB Icon: Card is connecting to USB data port and be recognized as a HID device

w/o USB Icon: Card is connecting to USB but battery charging only

From Low to Fully-Charged:

> 1 hours.

From None to Low:

~ 30 minutes.

**We believe in a brave new world,
where you are the key to
everything.**

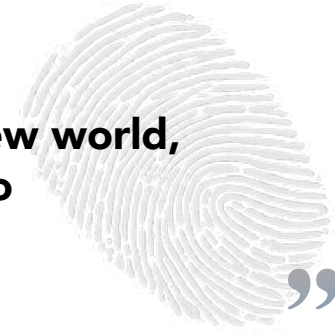

Enroll your Fingerprint First

- Connect your AT.Wallet card to the App



Fingerprint Verification

- LED# 2 is blue flashing
- Login Wallet
- Transaction – Sending payments



8 x Fingerprints

- Any enrolled fingerprint can login Wallet



Make Your Wallet Secure

- Designed by EAL 5+ SE
- Fingerprint-based security



Standalone Mode:

- Build-in E-ink display
- Multiple wallets, cryptocurrencies and languages support



USB+BLE Dual Interface:

- Compatible with the mobile app via BLE and works with a web browser via USB by a portable docking.





FCC Label Compliance Statement:

This device complies with Part 15 of the FCC Rules. Operation is subject to the following two conditions:

(1) this device may not cause harmful interference, and (2) this device must accept any interference received, including interference that may cause undesired operation.

To assure continued FCC compliance:

Any changes or modifications not expressly approved by the grantee of this device could void the user's authority to operate the equipment.

Exposure to Radio Frequency Radiation:

This equipment complies with FCC radiation exposure limits set forth for an uncontrolled environment. This transmitter must not be co-located or operating in conjunction with any other antenna or transmitter.



209-J00375



CCAO19LP0810T6

FCC ID: 2AOPY-ATWALLET01



THANK YOU!

 www.authentrend.com

 contact@authentrend.com

 [AuthenTrend](#)

 [AuthenTrend](#)

AUTHENTREND

20 August 2020